

Features

- Typical 7.0 x 5.0 x 1.3 mm ceramic SMD package.
- Conforms to AEC-Q200
- Output frequency up to 166MHz
- Tri-state enable/disable.

Typical Application

- xDSL, WLAN, Fiber/10G-Bit Ethernet
- Notebook, PDA
- PC main board, VGA card

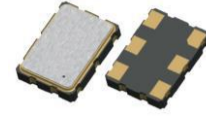

BS0507A Series

Parameter	3.3v		2.5V		1.8V		Unit	Conditions
	Min.	Max.	Min.	Max.	Min.	Max.		
Supply Voltage Variation	VDD-10%	VDD+10%	VDD-10%	VDD+10%	VDD-10%	VDD+10%	V	
Frequency Range	0.0137	166	0.0137	133	0.0137	125	MHz	
Supply Frequency	2.048, 25, 26, 27, 50, 66, 667, 100, 125						MHz	
Supply Current	-	1	-	1	-	1	mA	13.7kHz~70kHz
	-	10	-	8	-	7		0.3125MHz~35.328MHz
	-	20	-	18	-	15		30MHz~75MHz
	-	35	-	30	-	25		75MHz~133MHz
	-	45	-	40	-	-		≥133MHz
Output Level (CMOS)	2.97	-	2.25	-	1.62	-	V	Output High
	-	0.33	-	0.25	-	0.18		Output Low
Transition Time: Rise/Fall Time	-	50	-	50	-	50	nSec	13.7kHz~70kHz
	-	5	-	5	-	5		0.3125MHz~100MHz
	-	3	-	3	-	3		≥100MHz
Tri-State Mode (Input to Pin 1)	2.31	-	1.75	-	1.26	-	V	Enable
	-	0.99	-	0.75	-	0.54		Disable
Standby Current	-	10	-	10	-	10	uA	
Output Drive Capability (CL)	-	15	-	15	-	15	pF	
Period Jitter(Pk-Pk)	-	40	-	40	-	40	pSec	
RMS Phase Jitter	-	1	-	1	-	1	pSec	Integrated 12 kHz~20 MHz
Start Time	-	5	-	5	-	5	mSec	
Aging	-	±3	-	±3	-	±3	ppm	@ 25°C, First Year
Storage Temp. Range	-55	125	-55	125	-55	125	°C	
FREQ. STABILITY vs. TEMP. RANGE		±20ppm		±25ppm		±50ppm		
	-10~+60	Available		Available		Available		
	-20~+70	Conditional		Available		Available		
	-40~+85	Conditional		Available		Available		
	-40~+125	Not Available		Not Available		Available		

Note: not all combination of options are available. Other specifications may be available upon request.

Reliability

Parameter	Condition
Stress Test	IEC60068, GJB360B
Test	IEC60068, GJB360B
EMC Test (ESD)	IEC61000, JESD22
Solderability	EIA/JESD22-B102-C
Contact Pads	Gold over Nickel
RoHS	RoHS Directive 2011/65/EU Annex II Recasting 2002/95/EC

Outline Dimension & Pin Connections

Unit:
mm

[TOP VIEW]

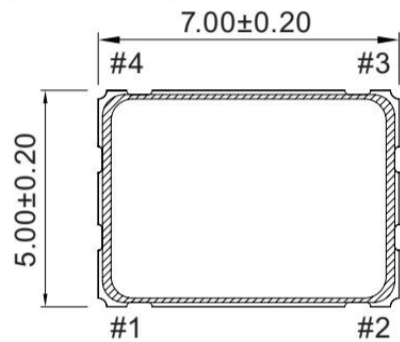

[BOTTOM VIEW]

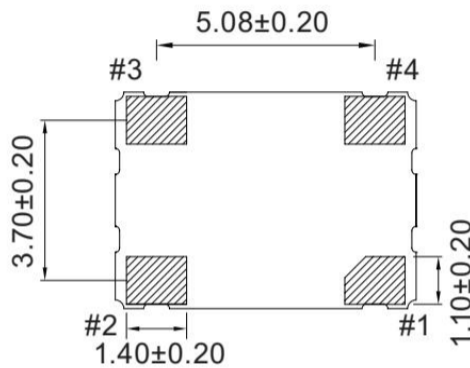

[SIDE VIEW]

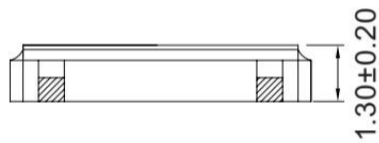

Pin#	Function
1	Tri-State
2	GND
3	Output
4	VDD

Ordering Guide

BS0507A X X X XXX X XXX.XX X

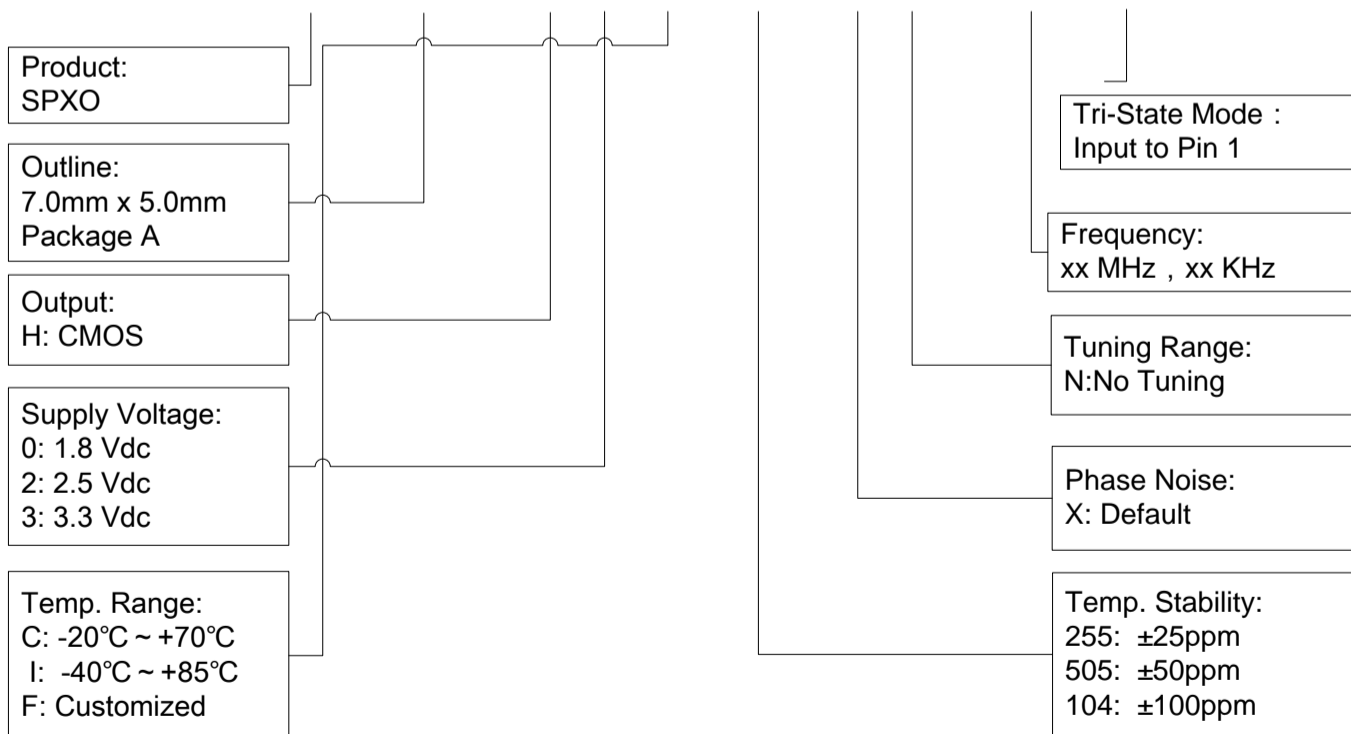

Example: BS0507AD3I505CN20

Disclaimer

Xtaltq Technologies Co., Limited reserves the right to make changes to the product(s) and/or information contained herein without notice. No liability is assumed as a result of their use or application. No rights under any patent accompany the sale of any such product(s) or information.